

# **REVOLUTIONS**

**BY** *Hunter*®

## **Solaris**

### **Owner's Manual**



• Assembly • Installation • Operation

Product: Ceiling Fan  
Trademark: Revolutions  
Quantity: 1 Piece  
Electrical Rating: 120V ~ 60Hz  
Weight  $\pm 2$  lbs: 17.6lbs (8.0kg)

**NOM**

This manual will help you install, operate, and maintain your new fan. These instructions are designed to make installation and assembly as simple and efficient as possible.



## **WARNING!**

**Important Instructions: Keep Instructions for future use**

Be sure to read the entire manual before beginning installation and save any extra parts for future use. The mounting of the suspension system shall be performed by the manufacturer, its service agent, or suitably qualified persons. Lift fan weight 8.0 kg. The fixing means for attachment to the ceiling such as hooks or other devices shall be fixed with a sufficient strength to withstand four times the weight of the ceiling fan. If unusual oscillating movement is observed, immediately stop using the ceiling fan and contact the manufacturer, its service agent, or suitable qualified persons. The replacement of parts of the safety suspension system device shall be performed by the manufacturer, its service agent, or suitable qualified persons. Blades must be more than 2.3m from the floor. The installation site must have an all-pole switch with a separation gap of at least 3 mm. To avoid possible electric shock, before wiring the fan, disconnect power by turning off the circuit breakers to both the outlet box and its associated wall switch location. If you cannot lock the circuit breakers in the off position, securely fasten a prominent warning device, such as a tag, to the service panel. All wiring must be in accordance with national and local electrical codes. If you are unfamiliar with wiring, you should use a qualified electrician. To reduce the risk of personal injury, do not bend the blade attachment system when installing, balancing, or cleaning the fan. Never insert foreign objects between rotating blades. This appliance can be used by children aged from 8 years and above and persons with reduced physical, sensory or mental capabilities or lack of experience and knowledge if they have been given supervision or instruction concerning use of the appliance in a safe way and understand the hazards involved. Children shall not play with the appliance. Cleaning and user maintenance shall not be made by children without supervision. It is recommended that children be supervised to ensure that they are not using the appliance improperly. To reduce the risk of personal injury, attach the fan directly to the support structure of the building according to these instructions and use only the hardware supplied.

# Congratulations!

---

You have chosen the best. Your new Revolutions ceiling fan will provide you with many years of comfort and satisfaction.

## Table of Contents

---

Unpacking Your Fan	4
Tools and Materials Required	5
Install Mounting Bracket	5
Select Type of Installation	6
Hang Down Style	6
Hugger Style	7
Electrical Connections	8
Blade Attachment	9
Light Fixture Installation	9
Operation	10
Troubleshooting	11
Maintenance	11

# Unpacking Your Fan

1. Unpack your fan and check the contents. Do not discard the box. If warranty replacement or repair is ever necessary, the fan should be returned in its original packaging. Remove all parts and hardware. Do not lay the motor housing on its side; the decorative casing may shift.
2. Examine all parts. You should have the following:

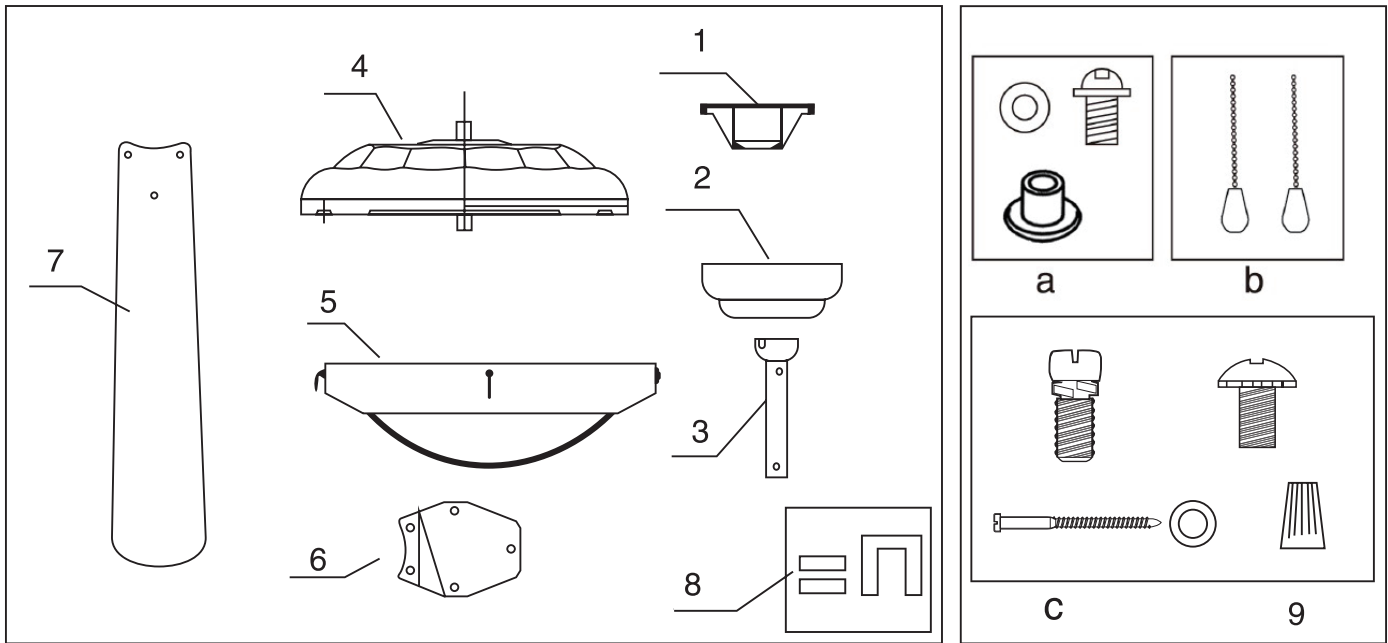

1. Mounting Bracket
  2. Canopy
  3. Downrod
  4. Fan housing, Motor, and Switch Housing
  5. Light Kit
  6. Blade Arms
  7. Blades
  8. Balance Kit
9. Parts Pack Containing:
- a. Blade attachment hardware (blade screws, nut, and washers for each blade)
  - b. Pull Chain/Fob
  - c. Mounting bracket hardware (extra screw and washer, wire nut, extra motor screw,)

**Note:** Some Revolutions fan models will have slightly different parts than shown here, depending upon the model. Basic installation procedures are similar for all fan models.

# Tools and Materials Required

- Phillips screw driver
- Flat Head screw driver
- Adjustable pliers or wrench
- Step Ladder
- Wire Cutter
- Electrical tape



## Install Mounting Bracket

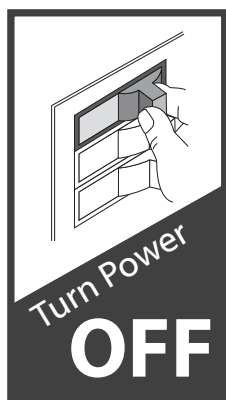

1. To avoid possible electrical shock, be sure electricity is turned off at the main power panel before wiring. All wiring must be in accordance with national and local electrical codes, and the ceiling fan must be grounded as a precaution against possible electrical shock.
2. Use mounting hardware.
3. The mounting bracket should be installed to the wooden structure of the ceiling joist with the two provided wood screws (Fig. 1).

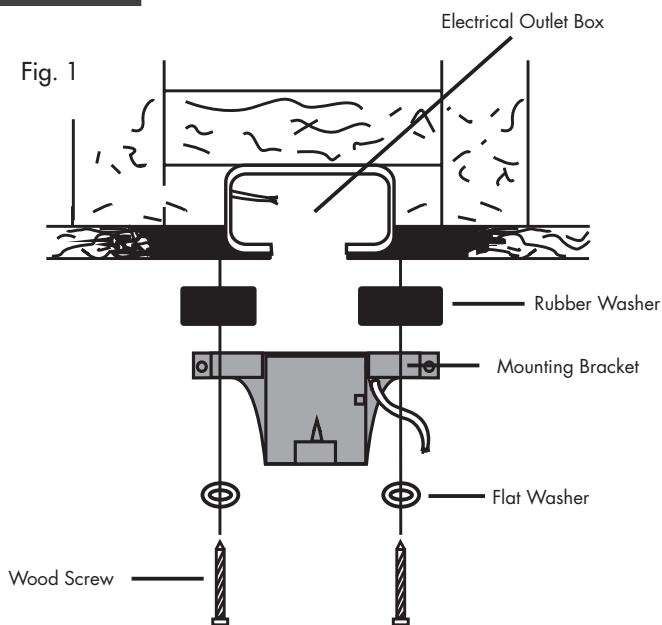

**CAUTION:** Electrical box must be wired to NOM general use wall switch. To reduce the risk of injury, turn off power at wall switch or main fuse or circuit breaker before attempting installation or servicing.

**WARNING:** To avoid fire or shock, follow all wiring instructions carefully. Any electrical work not described in these instructions should be done or approved by a licensed electrician.

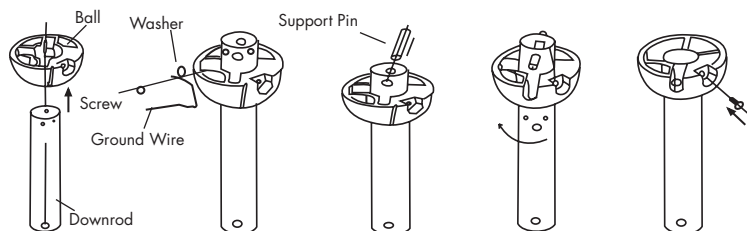

1. Disassemble the hanger ball from the downrod by removing the set screw and lock pin at the end of the downrod. Slide the hanger ball down the downrod and remove the support pin and green ground screw and wire.
2. Place the green ground wire ring terminal on the ground screw to the new downrod and tighten.
- 3&4. Place the hang ball on the new downrod and insert the support pin through the holes at the top of the downrod. Slide the hang ball up the downrod, putting the support pin into the slots of the hang ball.
5. Insert the set screw through the hang ball into the downrod and tighten.

# Select Type of Installation

## Hang Down

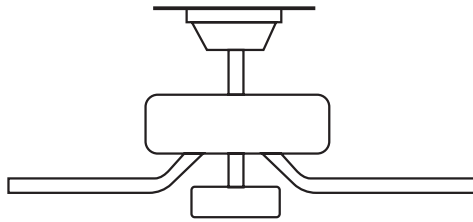

This method is preferred if the ceiling is sloped, vaulted, or if the ceiling is extra high and requires the use of a downrod.

## Hugger

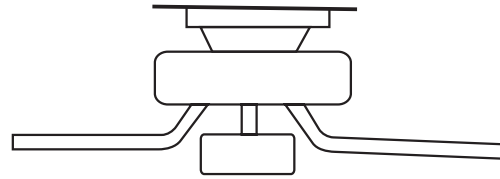

This method is preferred if maximum headroom is required. The ceiling must not be flat and not sloped.

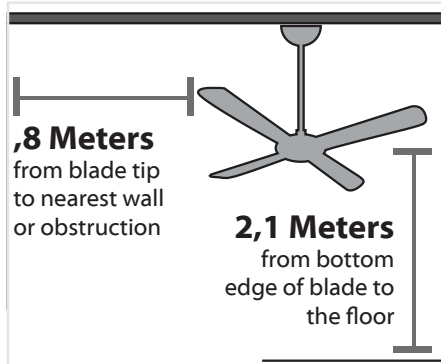

## CAUTION

To reduce the risk of injury to persons, install fan so that the blade is at least **2,1 m** above the floor.

# Hang Down Style

1. Slide the canopy onto the downrod (Fig. 2). Thread the power leads from the fan through the canopy and downrod. Take care not to pull excessively on power wires. Damage and loose connections could result from any abnormal pressure on these wires. Set the downrod into the yoke. Rotate until the holes match. Be careful not to damage the wiring. Insert connector pin through the holes (Fig. 2A and 2B). Secure the pin by inserting the stop pin through the connector pin.

Fig. 2

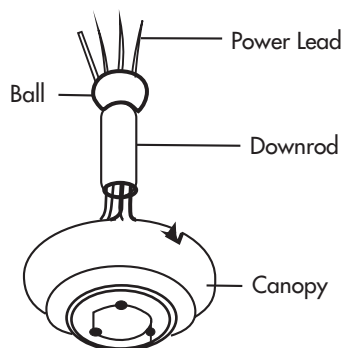

Fig. 2A

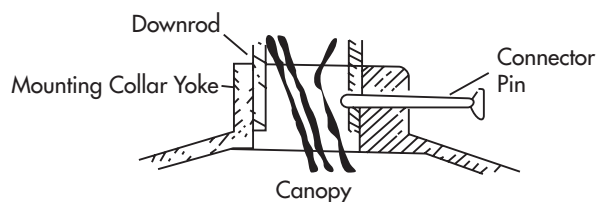
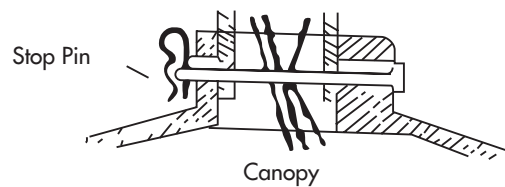

Fig. 2B



**WARNING:** Do not force the connector pin through the downrod. Use of force could cause damage to the wires inside. Make sure the stop pin is properly engaged to prevent it from falling out. Failure to properly install locking pin as noted could result in fan loosening and possible falling.

2. Tighten the two downrod setscrews. Some models have locknuts for the setscrew to ensure the setscrew is fully seated against the down rod. It is necessary to back off the locknut until it contacts the setscrew head prior to tightening the setscrew. When the setscrew is tightened against the downrod, the locknut should then be tightened against the connector yoke. Repeat for both (Fig. 3).
3. Tighten the motor setscrew. Check the strength of the connection (pre-tightened at the factory) by holding the motor housing in position and turning the downrod counter clockwise. If this connection slips, retighten the motor setscrew and locknut. Follow the same procedure mentioned above for the downrod setscrews.
4. Install ball into hanger bracket opening. The tab opposite of the hanger bracket opening should fit in slot on ball (Fig. 4).
5. Make wire connections (refer to section titled "Electrical Connections").
6. Slide the canopy up and fasten to the hanger bracket with the four screws provided.

**WARNING:** To avoid damaging the blade arms and blades, do not install either until the fan is fastened to the ceiling. To avoid motor shift, handle fan by downrod or switch housing only.

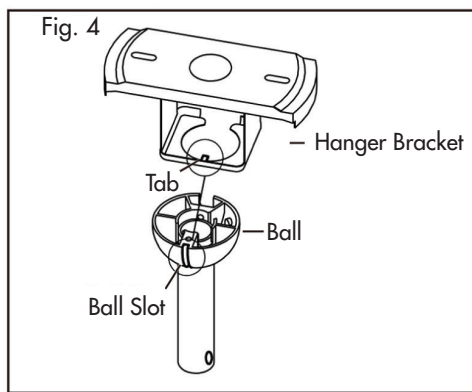
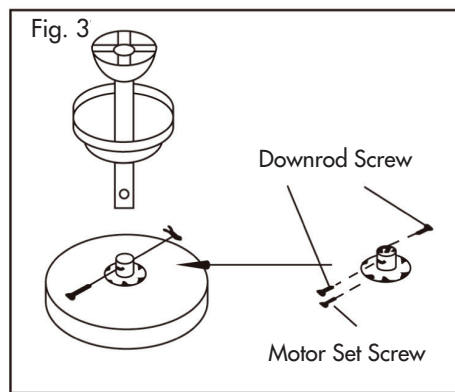

## Hugger Style

1. Fasten the canopy directly to the top of the fan motor housing with the three screws provided. (The downrod and ball are not used for this installation) (Fig. 5A). If a metal ring washer with three holes is provided, use it to install the canopy.
2. Hang the canopy (with the fan motor housing attached) from the tab on the hanger bracket (Fig. 5B). This will allow you to make the electrical connections without having to hold the fan up.
3. Make the wire connections (refer to the section entitled "Electrical Connections").
4. Put two screws in the hanger bracket, leaving them partially out (Fig. 5C).
5. Place the canopy up on the hanger bracket by inserting the slotted opening of the canopy on the screws (Fig. 5D).
6. Insert the remaining screws through the remaining canopy holes and tighten all four screws.

**WARNING:** Failure to completely tighten the screws in step 1 could result in fan loosening and possibly falling.

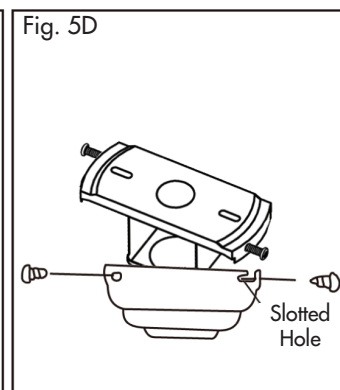
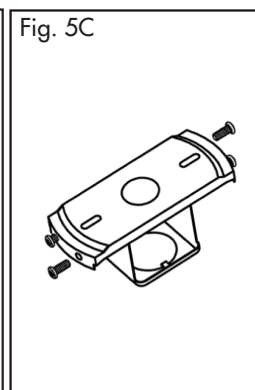
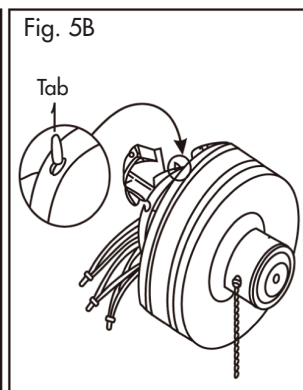
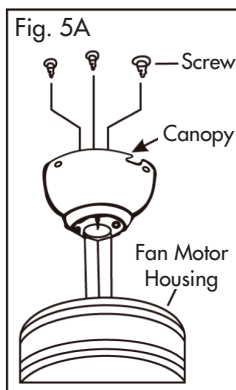

# Electrical Connections

1. Four wires are connected to the top of the fan.  
Black: "Hot" Power for the fan  
Blue: "Hot" Power for the Light  
White: "Common" For the fan and light  
Green: Ground Wire
2. If fan and light are to be connected to the same circuit, the black and blue wires should be connected together to the black wire in the ceiling using a wire nut to make the connection. If a light kit is not being installed, the blue wire should be left unconnected.
3. The white wire from the fan should be connected to the white wire in the ceiling, using a wire nut to make the connection.
4. The green wire from the fan should be connected to the ground wire in the ceiling, using a wire nut to make the connection.
5. Tuck your completed wiring back up into the electrical box.

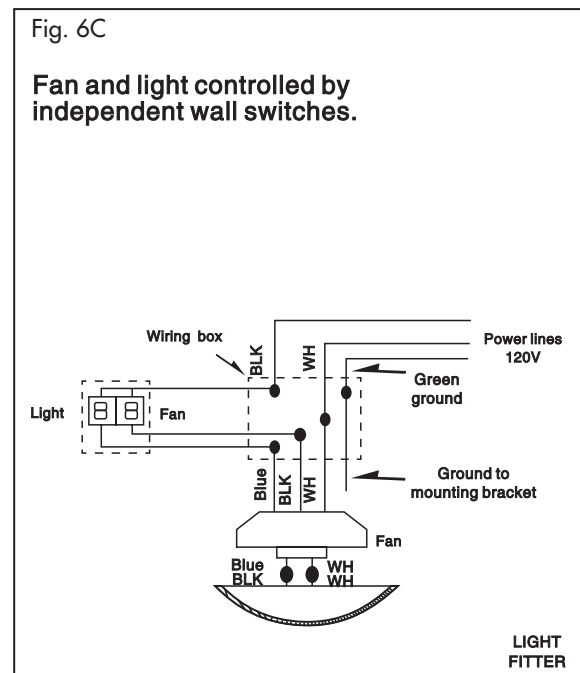
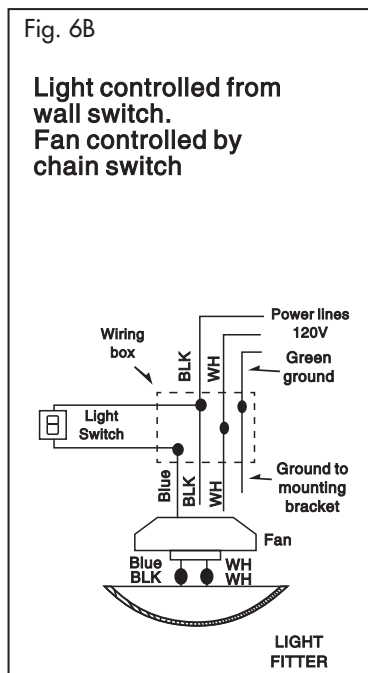
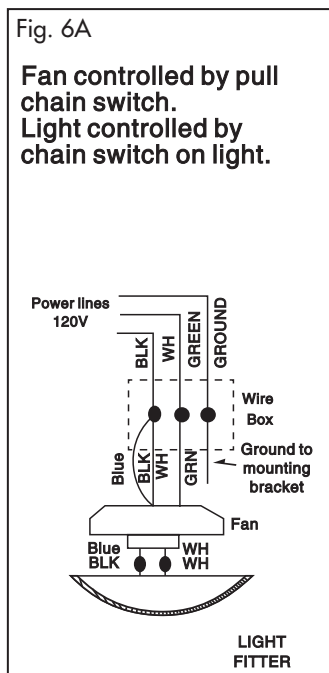

**WARNING:** To avoid possible electrical shock, be sure electricity is turned off at the main fuse box before wiring.

**NOTE:** If you are not sure the electrical box and fan are grounded, contact a licensed electrician for advice. They must be grounded for safe operation.

**WARNING:** Each wire nut (wire connector) supplied with this fan is designed to accept up to one 12 gauge house wire and two wire from the fan. If you have larger than 12 gauge house wiring or more than one house wire to connect to the fan wiring, consult an electrician for the proper size wire nut to use.

**WARNING:** Check to see that all connections are tight, and that no bare wire is visible at the wire nuts.



# Blade Installation

1. Attach blade brackets to blades using the blade bracket screws (1), fabric washers (2), and nuts (3) provided (Fig. 7A).
2. Check the motor for plastic shipping stabilizer tabs (1), and remove them if they are present.
3. Attach blade assembly to motor using the provided motor screws. To attach the blade assembly, rotate the installation window on the bottom of the light kit. Install the provided motor screws through the installation window and into the motor. Rotate the installation window to install each blade assembly to the motor.
4. Tighten screws securely (Fig. 7B).

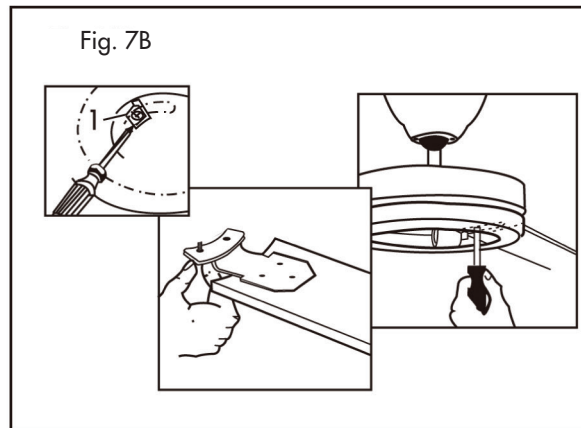
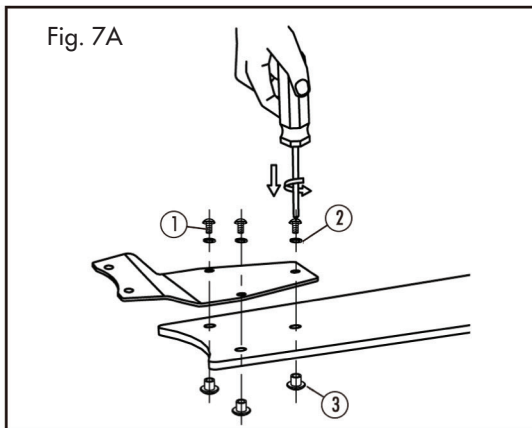

# Light Fixture Installation

1. Connect the 9-pin plug from the light kit to the 9-pin plug coming from the fan.
2. Attach the light kit to the fan using the included light kit screws.
3. Tighten screws securely.

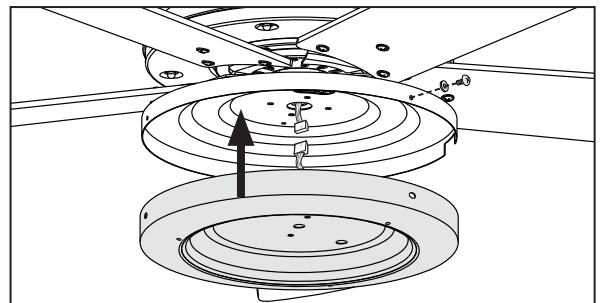

4. Install the light bulb.

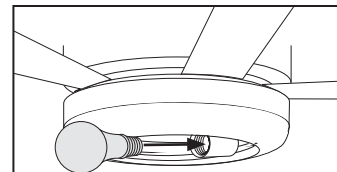

5. Raise the glass to the light kit.
6. Install the decorative screws by hand to hold the glass in place.

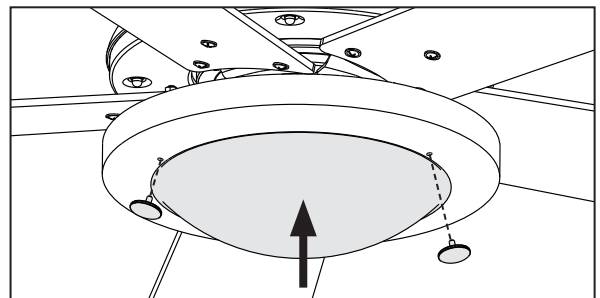

# Operation

1. Restore electrical power by turning on the electricity at the main fuse box.
2. Turn on the wall switch
3. Your fan has 2 controls on the switch housing.

## Speed Control

Pull Chain Switch  
(pull gently)  
Pull Speed

- |   |        |
|---|--------|
| 1 | High   |
| 2 | Medium |
| 3 | Low    |
| 4 | Off    |

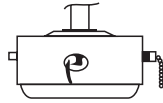

## Direction Control

Reverse Slide Switch  
(up and down)

Up for upward air flow to circulate air upward. Down for downward air flow for a cooling effect.

# Reversing the Fan

Turn the fan off and let the blades stop before changing the direction of the air flow. Engage the reverse switch to change the blade direction.

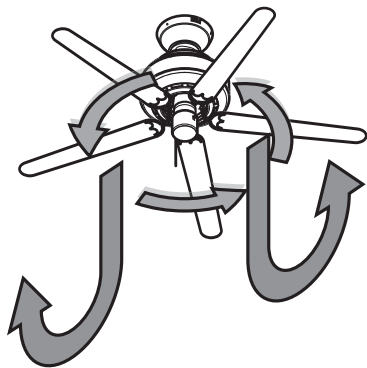

In warm weather, ceiling fans work best by blowing air downward (counterclockwise) providing the room with a cool breeze.

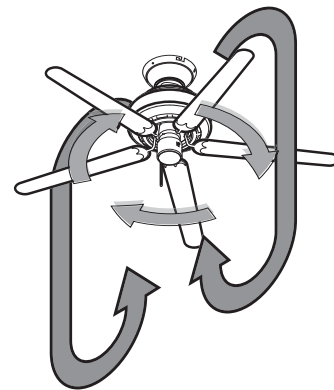

In cool weather, set your fan to draw air upward (clockwise) to distribute the warmer air trapped at the ceiling without causing a draft.

# Troubleshooting

## FAN WILL NOT START:

1. Check all fuses or circuit breakers. Replace if missing.
2. Turn off electrical power and check all wire connections to fan and in switch housing.

## FAN IS NOISY

1. Use of standard light rheostat or continuously variable fan speed wall control will always cause harmonic distortions or a humming noise. Many fan motors do not work quietly with solid state variable controls. If a quiet wall control is desired use only 3-speed NOM approved wall controls.
2. Always allow a few days 'break in' time for any new fan at medium or high speed. Try to diagnose the exact location of the noise by listening carefully from several sides (Blades, Motor, Light Kit, etc...). Fan noise can come from a light kit.
3. Make sure all screws in the fan assembly and light kit are tight and properly threaded. If not, back out and retighten. Tighten these screws at least once a year because they may loosen slowly over time and cause a clicking noise.
4. Make sure the light kit is securely fastened to the fan and all glass screws are finger tightened only. Do not tighten with pliers or a screw driver.
5. Make sure mounting bracket is installed snugly to junction box.
6. Make sure wire nuts in switch housing or canopy are not rattling against each other or against wall of housing. Wrap with electrical tape if necessary.
7. Make sure the canopy is not touching the ceiling.
8. Assure that the screws fastening blade arm to motor are tight and the lock washers provided for that purpose have been used.

## FAN TURNS BUT DOES NOT MOVE MUCH AIR:

1. The fan may be running in reverse, so air is directed upward.
2. The room may contain items that obstruct the air flow.
3. The fan may be too small for size of the room.

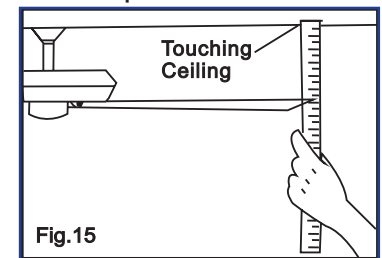

Fig.15

## FAN SHAKES OR WOBBLLES

1. A small amount of movement is considered acceptable and should not be considered a defect.
2. Make sure mounting bracket is tight at junction box/ceiling with no movement at all. Tighten screws if necessary.
3. Make sure all screws holding the blades to the blade arm and blade arm to motor are tight. Make sure light kit/glass screws are tight.
4. Some fan movement is normal. However, interchanging an adjacent (side-by-side) blade pair may redistribute the weight and result in smooth operation.
5. Most fan wobble problems are caused when blade levels are unequal. Check this level by selecting a point on the ceiling above the tip of one of the blades. Measure this distance as shown in Figure 15. Measurements deviation should always be within  $1/8"$ . Rotate the fan until the next blade is positioned for measurement. Repeat for each blade.

# Maintenance

1. The fan's natural movements may cause some connections to loosen. A clicking or rattling noise is a certain sign of loosening screws. Check the support connections, brackets, and blade attachments twice a year, and tighten all screws as necessary. Make sure all screws attaching the glass to the fitter on the light kit are finger tight. Do not use a screw driver or pliers to tighten glass screws.
2. Clean your fan periodically. Use only a cloth dampened with a mild detergent solution. Never use solvents. Dust with a soft cloth or brush. Metal finishes are finished with a lacquer to prevent tarnishing.
3. You will never need to oil your fan. Its permanently sealed bearings will provide silent, trouble free operation for many years.
4. Make sure the power is turned off at the main fuse or circuit panel before you attempt any repairs.

# Revolutions 52" Solaris Indoor Ceiling Fan

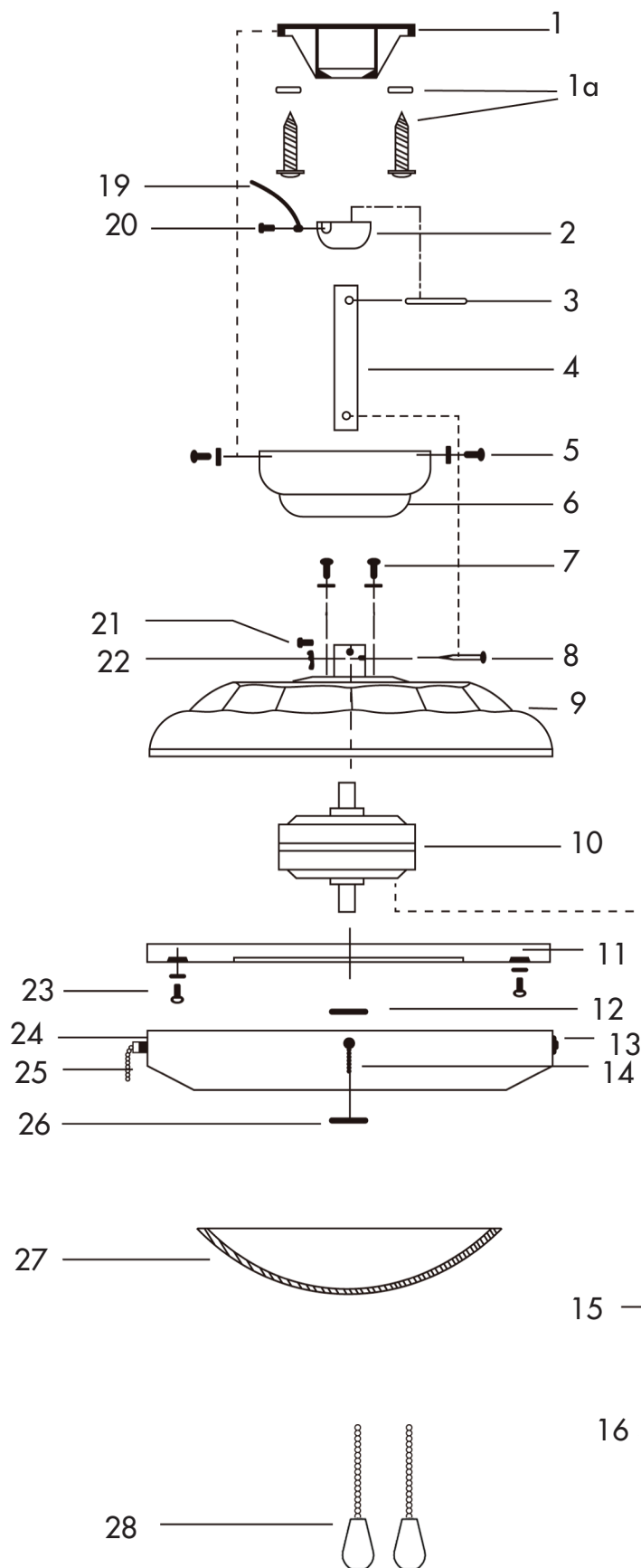

Part #	Description	QTY
1	Mounting Bracket	1
1a	Wooden Screws, Flat Washer	2
2	Ball	1
3	Pin	1
4	Downrod	1
5	Screws	4
6	Canopy	1
7	Screws	3
8	Pin	1
9	Upper housing	1
10	Motor	1
11	Lower housing	1
12	Nut	1
13	Reverse switch	1
14	Pull Chain Switch	1
15	Blade arms	5
16	Screws	10
17	Screws	15
18	Blades	5
19	Ground wire	1
20	Screw	1
21	Screw	2
22	Lock pin	1
23	Screws	1
24	Light housing	1
25	Pull chain switch	1
26	Nut	1
27	Glass shade	1
28	Fobs	2