



CEILING FAN HANDHELD CONTROL

Model 99198

CASABLANCA FAN COMPANY CONTROL LIMITED WARRANTY

This product is warranted to the original purchaser by Casablanca Fan Company against defects in material and workmanship for one (1) year from date of purchase. During the warranty period, we will repair or, at our option, replace a defective product at no charge. For information on how to obtain service, contact Casablanca's Service Department by calling our toll-free number at 1-888-227-2178. Damage to the product caused by mishandling, improper installation or modification is not covered by this warranty. This warranty is given in lieu of all other warranties expressed or implied. Some states do not allow limitations of time on an implied warranty, therefore the above limitations may not apply in every case. This warranty states specific legal rights which may vary from state to state.

READ AND SAVE THESE INSTRUCTIONS

This product conforms to UL Standard 1917.

⚠ WARNINGS

This device complies with part 15 of the FCC Rules. Operation is subject to the following two conditions: (1) this device may not cause harmful interference, and (2) this device must accept any interference received, including interference that may cause undesired operation.

This device complies with RSS-210 of Industry Canada. Operation is subject to the following two conditions: (1) this device may not cause interference, and (2) this device must accept any interference, including interference that may cause undesired operation of the device.

This equipment has been tested and found to comply with the limits for a Class B digital device, pursuant to Part 15 of the FCC Rules. These limits are designed to provide reasonable protection against harmful interference in a residential installation. This equipment generates, uses and can radiate radio frequency energy and, if not installed and used in accordance with the instructions, may cause harmful interference to radio communications. However there is no guarantee that interference will not occur in a particular installation. If this equipment does cause harmful interference to radio or television reception, which can be determined by turning the equipment off and on, the user is encouraged to try to correct the interference by one or more of the following measures: Reorient or relocate the receiving antenna, Increase the separation between the equipment and receiver, Connect the equipment into an outlet on a circuit different from that to which the receiver is connected. Consult the dealer or an experienced radio/TV technician for help. Note: Any changes or modifications to the transmitter or receiver not expressly approved by Hunter Fan Company may void one's authority to operate this remote control.

If you are installing multiple remote-controlled fans on the same circuit breaker,

you may need to perform a few extra steps to prevent interference or faulty operation of your remote controls.

Go to www.CasablancaFanCo.com/FAQs and click "How do I properly install multiple remote-controlled fans?" for more information.

INSTALLATION



The Casablanca Handheld Control requires an installed compatible receiver to function. Please follow the installation instructions included with the receiver prior to setting up your Handheld Control.

1 Turn off the power to the ceiling fan and receiver.

Power off the ceiling fan and pre-installed compatible receiver to prepare the receiver for pairing to the Handheld Control.

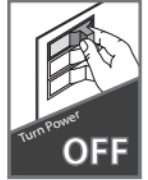

2 Open the battery compartment.

To access the battery compartment, slide the battery door upwards.

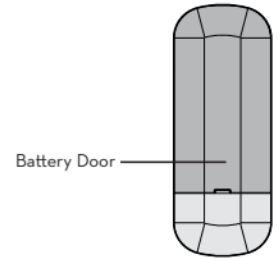

3 Install the battery.

Install two AAA batteries, found in the remote control hardware bag, into the transmitter. Reinstall the battery door.

Clean the battery contacts prior to installing the batteries. Please contact your local battery recycling center for proper battery disposal information.

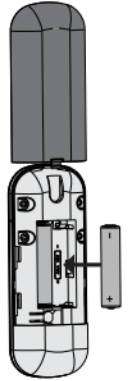

4 Turn power on.

Connect power to the ceiling fan and installed compatible receiver.

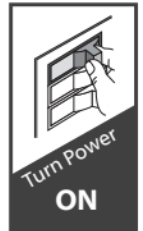

To avoid possible electrical shock, before installing or servicing your fan, disconnect the power by turning off the circuit breakers to the outlet box and associated wall switch location. If you cannot lock the circuit breakers in the off position, securely fasten a prominent warning device, such as a tag, to the service panel.

5 Pair the remote with a compatible receiver

Within three minutes, press the pair button on the remote. If pairing was successful, a single beep will sound. Replace the battery door and Phillips head screw.

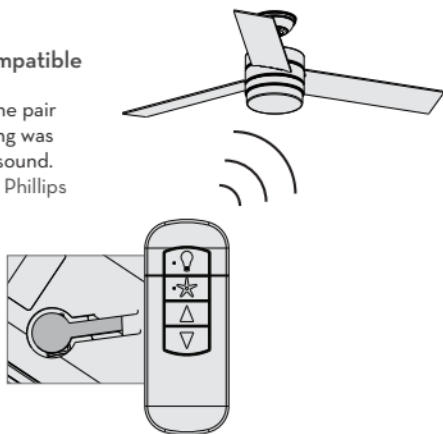

6 Install the Handheld Control cradle bracket.

You have two options to install the included Handheld Control cradle to the wall. Choose which path works best for you.

Option 1: Using Screws



Remove the cradle from the cradle bracket.

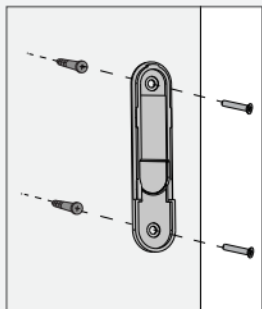

Choose your cradle installation location.

If you are installing into drywall, drill two 9/64 width holes using the cradle bracket as a guide. Gently hammer the included drywall anchors into the pre-drilled holes. Install the cradle bracket to the wall with the included screws.

Option 2: Using Adhesive Strip



Remove the cradle from the cradle bracket.

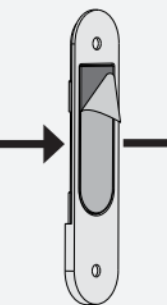

Apply the adhesive sticker to the back of cradle bracket per the instructions on the adhesive sticker.

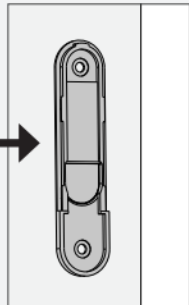

Press the cradle bracket against the wall and hold firmly for 30 seconds.

7 Install the Handheld Control cradle.

Slide the cradle onto the mounted bracket.

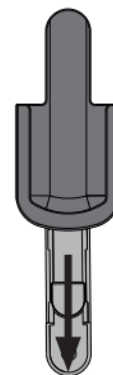

REMOTE FUNCTIONS

Key Press

Function

Lightbulb icon + Quick Press

Light On/Off

Lightbulb icon + Long Press

Light Dimming

Star icon + Quick Press

Fan On/Off

Up arrow icon + Quick Press

Raise Fan Speed

Down arrow icon + Quick Press

Lower Fan Speed

Long Press Up arrow icon

Fan High

Long Press Down arrow icon

Fan Low

Long Press Down arrow icon + Up arrow icon

Dimming Mode On/Off

Star icon + Long Press

Fan Reverse

Long Press Star icon + Up arrow icon

Fan Updraft

Long Press Star icon + Down arrow icon

Fan Downdraft